

FRL FPR-1/2"f

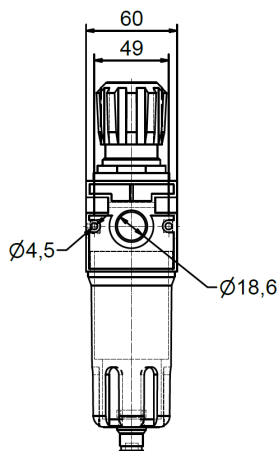

- Combines the technical benefits of the pressure reducer and the water separator with filter in one compact unit
- Pressure regulator with piston for high operational reliability
- Assembly independent of flow direction thanks to double-sided connection option for pressure gauge

- Working pressure range : 0-12 Bar
- Entry pressure: 0-18 bar
- Filter element: 20 µm

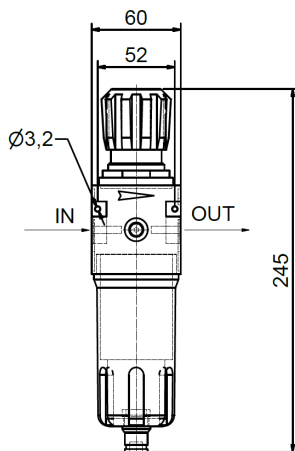

Specifications

Inlet Connection	1/2" Female BSP thread
Outlet Connection	1/2" Female BSP thread
Manometer Connection	1/2" Female BSP thread
Flow rate	2.500 l/min
Condensate tank volume	45 ml
Dimension	60x60x245

Ordering Information

Ordering Information	Weight KG
2813 9200 16	1,114